

RALPH LAUREN

SINGLE TIME MODELS

SINGLE TIME MODELS

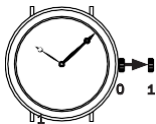

SETTING THE TIME: TWO-HANDS WATCHES

- Pull out the crown as far as it will go to position 1.
- Turn the crown in either direction to adjust the time as desired.
- Once you have made the adjustment, push the crown back in firmly to position 0.

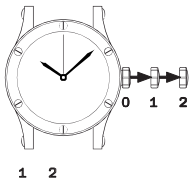

SETTING THE TIME: THREE-HANDS WATCHES

- Pull out the crown as far as it will go (position 2).
- Turn the crown in either direction to adjust the time as desired.
- Once you have made the adjustment, push the crown back in firmly to position 0.